

Center Newsletter
Late Spring/Early Summer 2025

A Non-Profit Child Care and
Education Program

Serving the
Cal State L.A.
Community



Program/Community Development



Teacher
Appreciation
Week!

Thank you parents for showing your appreciation for our wonderful teachers. Your notes, kind gestures and generosity were heartfelt and appreciated!



New Dinosaur
Garden

Our children found a pleasant surprise when on the preschool patio they found a new play space with multiple dinos and a Jurassic themed garden to match! Thank you to our awesome grounds and custodial crew, Miguel and Esmerelda!

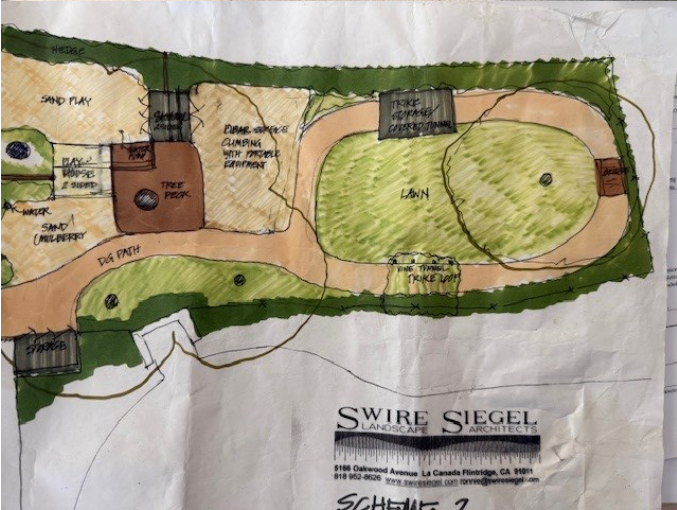

New Fenced
Playground in the
Works!

Over the next months and upcoming year, we will be adding an additional toddler/preschool play yard to the front area of the Center. Included will be a bike path, butterfly garden, nature spaces and sandbox.

Calendar

Late Spring into Summer Calendar

- May 13** - PAC sponsored Bubble show for all children 10:30 am
- May 14** - PAC Yoga and Planting 5:30 pm –6:30 pm on courtyard and Atelier
- May 23** - Preschool goes to the LA Zoo (All children must be present in the classroom by 9:00 am)
- May 26-** Center **CLOSED** for Memorial Day
- May 30** - ABACC Open House and Ice Cream Social 5:00 pm to 6:30 pm
ABACC is sponsored in part by:



Please visit our parent resource page on our website:
<https://www.calstatela.edu/abacc/parent-resources-and-information>
Scroll to Parent Resources and Education

Upcoming Event!



Please join us for Open House on
Friday, **May 30, 2025** from
5:45 pm–6:30 pm
ALL classrooms will be open for touring.
Come see what the children have been up to
this spring!
BRING THE FAMILY!



Grab a scoop before open house at
5:00 pm to enjoy in the courtyard.
*Children can enjoy ice cream with their families once they are picked up from their classroom.
*Parking will be available in LOT E, across the street for a small fee.

Program News!

Additions to our Team!

Taisandra Robles—Preschool Teacher (Magnolia)
Katherine Gutierrez—Preschool Teacher (Maple)

As part of their orientation process, Taisandra and Katherine will be traveling to Boulder Journey School (BJS) for an intensive study tour of the Reggio Emilia approach through the lens of BJS. Administrators, Vanessa Perez and Jim Goodrich will assist in guiding the tour with BJS faculty.

Ethan Glover—Part-time Associate Teacher (Infant/Toddler Program)
Rachel Naranjo— Part-time Associate Teacher (Infant/Toddler Program)

We are happy to be adding the new position of part-time Associate Teacher to the infant/toddler classroom support system. These associate teachers are hired through our corporate agency and are not required to leave the program once they graduate from Cal State LA. This allows us to keep these teachers for a longer stretch of time to add more consistency to the program. These Associate Teachers will also be required to hold a Teacher’s Permit so they will be able to step into to a lead role should the main teacher need to be out of the room.

Staff Development and Program Quality Assessment

- The Center has been providing on-going **RIE training** for our Infant/Toddler teachers. Teachers have been working with a RIE coach every other week to reflect on and implement the RIE approach. For more info on the RIE Approach: <https://rie.org/>
- The **Preschool Teachers** have been training and working on preparing the classrooms and staff for an observation using The **Classroom Assessment Scoring System® (CLASS)**. For more info on CLASS go to: <https://teachstone.com/class/>
- Subsidized families will be emailed to take part in a **survey** during mid-May from the California Department of Education. The survey will provide us data we can use to reflect and improve upon the program for families on a grant program.
- In June, the Center will maintain its 33rd year of NAEYC Accreditation through the Center’s successful completion of its Annual Report and Review process.