

EAGLE PRIDE TIMES

CSULA HOUSING SERVICES

5300 Paseo Rancho Castilla
Los Angeles, CA 90032
Office: (323)343-4800
Fax: (323)343-6465
www.calstatela.edu/univ/housing

ISSUE 9

DECEMBER 2011

INSIDE THIS ISSUE:

Golden Eagles Apartments Update	1
Holiday Safety Tips	1
L.A. Winter Wonderland	2
Shopping Centers	2
Spelling Bee! Save the Date	2
Local Food and Dining	3
Insuring A Great College Experience	3
Fall 2011 Events (Pictures)	4
Graduation Initiative	4

Golden Eagles Apartments Update

SENIORS, want to transfer to a single occupancy apartment or suite? Here is your opportunity to submit a request to transfer to the Golden Eagles Apartments (GEA). To be eligible you must meet the following criteria:

- ❑ Senior status with at least 135 units (submit a verification from GET showing your unit total).
- ❑ Be 21 years of age or older
- ❑ University account must be current.
- ❑ Have no open or repeat conduct cases.
- ❑ Be able to pay the GEA

- rental rate.
- ❑ Submit a Transfer Request Form.
- ❑ Fill out a Single Request Form

The Golden Eagles Apartments will be opening for the 2012 Winter quarter with mostly single occupancy apartments and

limited double occupancy. You will have the opportunity to choose from single occupancy in a

2-bedroom apartment, single occupancy in a 3-bedroom suite, or double occupancy in a 1-bedroom apartment. Space is limited and on a first-come, first-served basis.

If you have any questions or want to pick up a Transfer and Single Request Forms, stop by the Housing Services office or call (323)343-4800. You

can also visit the Graduate Housing website for rates, floor plans and more: www.calstatela.edu/univ/housing/Graduate_Housing.php.

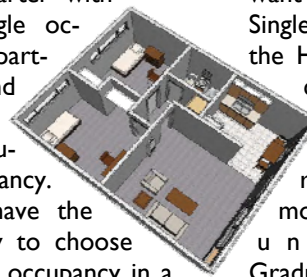

Holiday Safety Tips

'Tis the season! With finals out of the way and term papers a thing of the past (at least until Winter quarter), the time has come to sit back, relax, and catch up on sleep. The first quarter of the academic year has finally come to an end.

Before you start packing to go home for the holidays or settle in your snuggie with hot chocolate to watch movies on the Housing Channel, here are a few safety tips for a safe and joyous winter break:

- * Do not block or conceal fire extinguishers, fire alarm boxes, or any other emergency feature with

holiday decorative material.

- * Live Christmas trees are not allowed, however, non-flammable, artificial trees are acceptable.
- * Use only UL-approved lights. Never link more than three strands to one extension and check your lights for broken or cracked sockets, frayed or bare wires, or loose connections. Defective holiday lights are one of the leading causes of holiday-decorating related fires.
- * Keep your windows and patio doors shut and locked especially during

the break when there are fewer neighbors around to keep an eye out for suspicious activity.

Going Home for the Holidays:

- * Turn off and unplug all devices that do not require constant energy.
- * Give away or toss all food that will spoil while you're gone.
- * Remove all trash from the apartment and toss in the large trash bins inside the brick enclosures.
- * Lock your windows and doors, especially if your roommates will also be going away.

Campus Closures

The Housing Services office and Community Information Center (CIC) will be closed December 19-26, 2011. To reach the RA on duty, call (323) 343-4807.

Work Order

To submit a work order, visit the Housing Portal (housing.calstatela.edu/StarRezPortal) and click on 'Maintenance' and follow the instructions to report the problem.

Dining Room

No meals will be served during quarter break December 11, 2011 through January 8, 2012

Welcome New Housing Staff

- Fausto Esaquivel
- Gena Merlo
- Kimberly Taylor

L.A. Winter Wonderland

Sunny SoCal is not your ideal location to go building a snowman but that doesn't mean winter season can't be just as much fun. With the help of DiscoverLosAngeles.com, we bring you the winter installment of Things To Do In L.A.:

The Music Center

The Music Center in Downtown hosts a variety of events from sing-alongs to the city's largest holiday celebration. Visit discoverlosangeles.com/play/events/music-center-holiday-events.jsp for their schedule.

Las Posadas

December 16th until Christmas Eve, merchants and their families walk through El Pueblo de

Los Angeles Historical Monument. The annual tradition features a procession with call-and-response singing and piñata breaking. It is one of the oldest events in the city.

One of LA's signature holiday traditions: Ice Skating. Here are a few popular locations:

Downtown on Ice at Pershing Square

Nov. 17, 2011 - Jan. 16, 2012
www.laparks.org/pershingsquare/doi.html

LA Kings Holiday Ice at L.A. LIVE

Nov. 26, 2011 - Jan. 5, 2012
lalive.com/offers/offer-detail/122/holiday-ice

CHILL at W Los Angeles - Westwood

Nov. 18, 2011 - Jan. 1, 2012
www.wlosangeles.com/chill

ICE at Santa Monica Nov.

11, 2011 - Jan. 16, 2012
www.iceatsantamonica.com/index.html

Woodland Hills Ice

Oct. 21, 2011 - Feb. 5, 2012
www.woodlandhillsice.com

Downtown on Ice | Photo by mogi via Flickr



Shopping Centers Near CSULA

Looking to do some holiday shopping? Don't know where to go? From malls, to outdoor shopping centers, we've got you covered!

Old Town Pasadena

Colorado Blvd. between Pasadena Ave. and Arroyo Pkwy, Pasadena, CA 91101

Glendale Galleria

100 West Broadway, Suite 700 Glendale, California 91210

Montebello Town Center

2134 Montebello Town Center Dr. Montebello, CA 90640

Santa Anita Westfield Mall

400 S. Baldwin Ave. Suite 231 Arcadia, CA 91007

Paseo Colorado

280 East Colorado Blvd. Pasadena, CA 91101

Atlantic Square

2000 S. Atlantic Blvd. Monterrey Park, CA 91754

Citadel Outlets

100 Citadel Drive Commerce, CA 90040

Spelling Bee! Save the Date!

Tues. Jan 17th 2012 at 7pm

Phase II Lounge - Residents may have some nostalgia of participating in a spelling bee in grade school and will be given a chance to be crowned the winner of the spelling bee in Housing! A fun interactive spelling bee will test residents' spelling

skills and one resident will walk away with a gift card from Barnes and Nobles where they can extend their academics through educational books.

If you are interested in participating in the spelling bee, you can contact, RA, Natasha, at nburana@calstatela.edu

or leave your contact information with the RA on duty at the Community Information Center (CIC) in Phase I.



Local Food and Dining

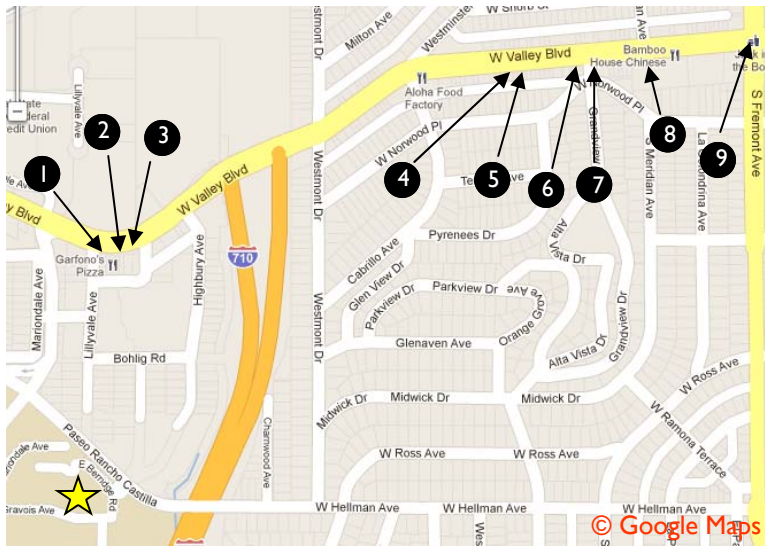

Did you know you can dine Greek, Italian, Mexican and American all within walking distance from Housing? Here are some of your local restaurants and

1. Garfono's Pizza
2. Chris's Pit Stop
3. Valley Foods Mini Mart
4. Palmero Bakery
5. Aloha Food Factory
6. KFC
7. La Parrilla Mexicana
8. Bamboo House Chinese Restaurant
9. Jack In The Box

Computer Lab
Open in Phase I for all residents. Printing is available.

Meal Plan
Sign up for the Winter Meal Plan. Stop by the Housing Services office or sign up online at www.calstatela.edu/univ/housing/mealplan.php

Mail Room
The Mail Room will be closed on December 24, 2011 and January 2, 2012

Readership Program
Pick up a copy of USA Today or L.A. Times Monday-Friday in the Phase I & II hallways.

Insuring a Great College Experience

Look around your room and take stock of all of the items you have brought with you to transform your apartment into a home, study space, and relaxation zone. If you are like the average Cal State LA Housing resident, you are most likely looking at your computer, mp3 player, gaming console, and cell phone. In addition to the necessary electronics, think about your wardrobe, décor, and any miscellaneous items like bicycles and barbecues. When monetarily assessing all of these items that are a part of your everyday life, you will find that they add up! The University has no insurance to cover personal or property damage (refer to License Agreement Terms & Conditions Section II.D). Consider taking out an insurance policy on those items and protect your investment in the case of loss, damage, or theft.

Types of Insurance:

- Homeowner's Insurance- Ask your parents or guardians if they have a pre-existing homeowner's policy. Some policies may be able to include your campus housing at no additional cost if your parent's home is your primary residence.
- Renter's Insurance- For the independent resident, a renter's policy may make the most sense. While there are higher costs associated with having this type of policy, the upside is that they are often customizable.

When Looking to Purchase Any Policy:

- Get quotes from as many vendors as you can.
- Check whether the policy covers replacement or the actual value of an item. You'll want a policy that pays re-

placement costs, that is the cost of getting a new item to replace the lost or stolen one.
-Find out what's included or excluded from the policy. For example, if the policy excludes fire or flooding, you may want to look for a more inclusive insurance policy.
-Look for a policy that covers losses not just in living quarters, but for school-sponsored trips.

Article content from bankrate.com and the CSULA Housing License Agreement Terms and Conditions





Grocery Runs

Need a ride to the market? Take our shuttle service for free. You can catch it in front of the Phase II Mail Room. Leaves Campus: 10am - 1pm. Return trips only: 1pm-2pm.
December 3, 17

Fall 2011 Events

Happy Holidays!

from the Housing Services and Residence Life staff

Winter Quarter
Classes begin January 9, 2012.

Finals Week
24-Hour Quiet hours
December 5-10.
GOOD LUCK!

Social Networks

Like us on Facebook or follow us on Twitter @CSULA Housing for updates on what is going on in housing!



Important Deadlines

- December 1, 2011** - Rent Due
- December 1, 2011** - Emergency Withdrawal period ends.
- December 5 - 10, 2011** - Final Examinations.
- December 11, 2011 - January 8, 2012** - Student Recess
- December 16, 2011** - Grades will be available to students to view in GET beginning 8:00 a.m.
- December 19 - 26, 2011** - Campus Closed

Graduation Initiative

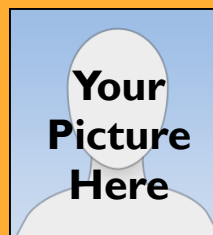

Be a part of the Graduation Initiative. We know the path to earn a degree is not easy. Share your journey, struggles and triumphs. Let us know what you are doing to achieve your goals for higher education and be an inspiration to others. Email your story to maria@cslanet.calstatela.edu (make sure to fill in 'Graduation Initiative'

on the subject line) and you can be featured in the next newsletter. You will also need to submit a picture and a Visual/Audio Release form. Call 323-343-4800 if you have any questions.

SUBMISSIONS

If you would like to make a submission to the newsletter, please email your article to: maria@cslanet.calstatela.edu.